

Building for our
FAITH
CAPITAL CAMPAIGN





DIocese of ARLINGTON

Office of the Bishop

200 North Glebe Road, Suite 914 • Arlington, Virginia 22203 • (703) 841-2511 • Fax (703) 524-5028

August 7, 2017



Dear Brothers and Sisters in Christ,

Since arriving in Arlington, I have had the opportunity to visit many parishes in the Diocese, and to celebrate Mass and meet parishioners. Through these encounters, I have been encouraged by the strong faith and zeal for the Gospel that are witnessed throughout the Diocese.

One of the parishes I have visited several times is St. Ambrose Parish where I was blessed to meet many of you. Father Fisher has shared with me the parish's master plan for building a beautiful new church and upgrading other facilities at Saint Ambrose. Your new church will be a gift to all who wish to encounter Jesus Christ, whether they be from the parish or visiting from other dioceses. In the process of designing a church, we are reminded that it is so much more than an ordinary building. A church gives us a sense of the sacred: a place to rest in the midst of the fast-paced world around us; to reflect on God; and to remind us of His glory, majesty and beauty.

As you continue towards the construction and completion of your building project, be assured of my prayers for your efforts and know that I look forward to dedicating the new church of Saint Ambrose Parish. May Our Lord Jesus Christ bless you in all of your endeavors.

Sincerely in Christ,

Michael F. Burbidge

Most Reverend Michael F. Burbidge
Bishop of Arlington





Dear Members of St. Ambrose Parish,

In 2013 our parish undertook the first step toward the construction of a new church and other facilities important to our Catholic mission of preaching the Gospel and caring for God's people. I am very excited to announce that we are now ready to move forward with the next phase of our building schedule. As your pastor I am asking for your help as we take this important next step toward making our plan a reality. The *Building for our Faith* Capital Campaign will seek to raise a significant portion of the money necessary for this project.

This brochure will review the progress we have made and discuss upcoming steps in the next phase of our master building plan. Our efforts in building a new church not only address the present needs of our community, but it will also benefit future generations, as together we work on building God's kingdom. I believe that in building a church we establish, not simply a space to come together in our worship of God, but more profoundly, a home where the very architecture proclaims the transcendental beauty and truth of God and, in turn, leads others to the faith we profess. Let us build a church where all can encounter the Lord Jesus, and be strengthened on our journey to Heaven.

Sincerely yours In Christ,

Reverend Andrew J. Fisher
Pastor



"Lord, I love the
refuge of your house,
the site of the
dwelling-place of
your glory."

- Psalms 26:8



OUR VISION

Floor plan



Building for our
FAITH
CAPITAL CAMPAIGN

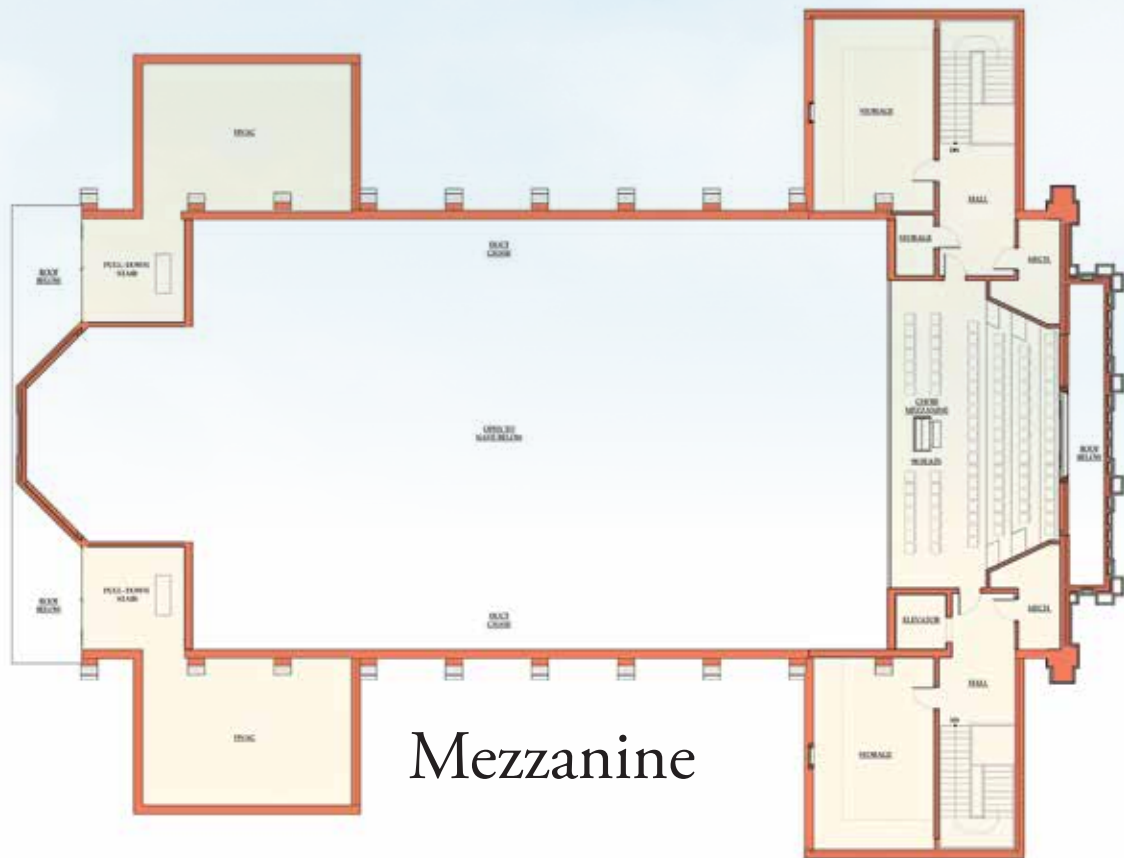



Building for our
FAITH
CAPITAL CAMPAIGN

Beginning in the Fall of 2010, following extensive discussions, consultations with the Arlington Diocese, and town hall meetings with parish families and families of the neighborhood, the decision was made to move forward with a Master Plan to address the physical needs of St. Ambrose parish, with a particular focus on the construction of a new church.

In 2013, St. Ambrose Parish conducted a capital campaign to raise money toward the parish master plan. Since that time, the parish has worked extensively with the Arlington Diocese, our Architects, and Fairfax County to prepare for the demolition of the current rectory, the installation of additional parking, the demolition and re-construction of the parish church building. It has been a very involved, complex and multi-faceted process and we are very excited about the progress that has been made. There is still more to do. Included in this brochure is a sampling of the key achievements to date and the remaining tasks and timelines.

Key Achievements to Date:

- Conceptual Design Phase:
 - Determining the Needs of the Parish
 - Development of Master Plan
- Zoning Board Approval
- Architect Provides Preliminary Conceptual Drawings
- Geotechnical Study
- Civil Engineer Study
- Construction Contractor Hired
- Final Site Engineering Completed

Remaining Tasks and Timelines:

- Architect Provides Final Design and Blue-Prints
- Final Review by Fairfax County of the Construction Plan
- Pre-Construction
- Groundbreaking
- Demolition of Current Rectory
- Installation of New Parking Lot
- Demolition of Current Church Building
- Construction of New Church Building
- Dedication of New Church Building by Bishop Burbidge



FINANCIAL PICTURE

Projected Costs:

Total Projected Costs:	\$12,500,000 - \$13,500,000*
Demolition of Current Rectory:	** (Phase 1)
Installation of New Parking Lot:	** (Phase 1)
New Church Building with Lower Level:	(Phase 2)
School (Classroom Expansion / Gym):	(Phase 3)
<i>To be determined at a later date.</i>	

** The total project cost includes such soft costs as Architectural, Engineering, Legal, Consulting and County fees and expenses. Construction costs are also dependent on market costs for materials and labor.*

*** Cost projections for the demolition of the current rectory and the installation of the new parking lot are represented through various soft cost estimates such as the civil and geotechnical evaluations, County review and approval of site plan, pre-construction clearing and site preparation, etc.*

2017 Building for our Faith Capital Campaign Financial Breakdown:

Total Funds Raised from Previous Campaign:	\$3,300,000
2017 Building for our Faith Campaign Goal:	***\$3,000,000
Projected Loan from Arlington Diocese:	****\$7,500,000 - \$10,000,000

**** The money pledged during the 2017 Building for our Faith Capital Campaign will be included within the total amount of the loan from the Diocese of Arlington. The loan will allow the parish to move forward with Pre-Construction and Construction activities. As the pledges from the current campaign are paid, they will be directed toward future loan payments.*

***** The total loan amount will be determined by both the need and the ability of the parish to make loan payments and maintain a cash flow over the course of the life of the loan.*



NEED FOR GENEROSITY

CAMPAIGN OVERVIEW

The parish community of St. Ambrose Parish would like to offer an opportunity for every parishioner to participate in our Building for our Faith Capital Campaign, and to support our parish needs. Through the involvement and generosity of all the members of our community, we will successfully reach our goal. Every parishioner is invited to attend a reception and learn more about the current progress and forthcoming steps in the next phase of our master building plan. All parishioners are asked to make a pledge by returning a completed pledge card. The success of our campaign depends on the participation and generosity of all our parish members. Throughout our campaign, every parishioner will be asked to:

- Reflect on how greatly God has blessed us as individuals and as a parish community.
- Give thanks to God for these blessings.
- Prayerfully consider how their involvement with this campaign can reflect their gratitude to God and our Church.

HOW TO PLEDGE YOUR SUPPORT

Every member of our parish community is integral to the future growth and development of our church, and therefore, each family is asked to consider a pledge to the campaign to the best of their ability. Our goal at St. Ambrose Parish is to raise \$3,000,000 through the efforts of this campaign. Everyone is asked to prayerfully consider how their generosity can reflect their gratitude for the gifts that God has given them. While any amount, small or large, is welcomed and will help us achieve our goal, each family is asked to consider a pledge of \$5,000 or more, payable over three years. **A pledge of \$5,000, after a 10% down payment of \$500, is \$125 per month or \$4.11 per day.**



WE ARE ALL MEMBERS OF A MUCH LARGER FAMILY

All of us are members of families who help each other in times of need. Here at St. Ambrose Parish we are also members of a much larger family, our faith community. Now we turn to you, our parish family, for assistance. Each family member, in his or her own special way, has been generous to our parish. Even the simple act of registration shows a commitment of faith and an identity with the community. Continuing that spirit of generosity, we request a pledge of financial and prayerful support from all our families. We invite parishioners that call St. Ambrose Parish their spiritual home to take this opportunity to help maintain what past generations have entrusted to us, and in that same spirit, provide for future generations. We pray that all members of our parish family will fully support this project.



Suggested Pledge Chart

Total Gift	10% Down Payment	3 Annual Payments	6 Semi-Annual Payments	12 Quarterly Payments	36 Monthly Payments	Daily Sacrifice
\$500,000	\$50,000	\$150,000	\$75,000	\$37,500	\$12,500	\$410.96
\$250,000	\$25,000	\$75,000	\$37,500	\$18,750	\$6,250	\$205.48
\$100,000	\$10,000	\$30,000	\$15,000	\$7,500	\$2,500	\$82.19
\$75,000	\$7,500	\$22,500	\$11,250	\$5,625	\$1,875	\$61.64
\$50,000	\$5,000	\$15,000	\$7,500	\$3,750	\$1,250	\$41.10
\$25,000	\$2,500	\$7,500	\$3,750	\$1,875	\$625	\$20.55
\$20,000	\$2,000	\$6,000	\$3,000	\$1,500	\$500	\$16.44
\$10,000	\$1,000	\$3,000	\$1,500	\$750	\$250	\$8.22
\$7,500	\$750	\$2,250	\$1,125	\$562.50	\$187.50	\$6.16
\$5,000	\$500	\$1,500	\$750	\$375	\$125	\$4.11

The gift plans in this brochure are provided as a suggested guideline when considering your pledge. Please review the gift plans carefully and select one that fits your household's financial ability. Payment amounts are calculated assuming a 10% down payment for each pledge.

AS YOU MAKE YOUR PLEDGE, PLEASE REMEMBER...

- Make checks payable to **St. Ambrose**.
- All donations made to this campaign will be deposited into the capital campaign fund and will be used exclusively for the case items presented in this brochure.
- Payments can be made over a period of three years or longer, if necessary.
- All contributions to the campaign are fully tax deductible for those who itemize their taxes.
- Pledge payments are in addition to your regular offertory. The Sunday offertory collection pays for the day-to-day operations of the parish, while your pledge in this campaign will be used specifically for capital campaign case items.
- Pledges are not legally binding, but rather an indication of your intention to donate.
- You may return the pledge card in the weekly collection, bring it by the parish office or return it in the mail.

If you have any questions about the campaign or making your pledge, please contact the parish office at (703) 280-4400.



*Not everyone can make
the same size gift,
but everyone can make
the same size sacrifice.*

GIVING OPTIONS

PLEDGES VIA CASH OR CHECK

Simply complete your pledge card by selecting the amount of your pledge and down payment (optional, but encouraged).

- Select your schedule of payment, i.e., monthly, quarterly, semi-annual or annual payments.
- Please make checks payable to **St. Ambrose**.
- Payment reminders will be mailed along with a special payment envelope in accordance with the plan you choose.
- Once completed, please return your pledge card in the weekly collection, bring it by the parish office or return it in the mail.

GIFTS OF STOCK

Donors can use their own broker/agent or the parish agent to transfer and sell stock.

- If the stock has been held long-term (over one year), the donor does not have to pay capital gains tax on the stock, and is allowed a tax deduction for the full value of the stock.
- Donors may also choose to sell stock in order to claim a loss, which may be beneficial for tax circumstances.
- In either case, the stock must first be transferred to the parish before being liquidated. Please contact the campaign office for more information.

Online Giving - Pledges Via Credit/Debit/Automatic Draft:

If you wish to make your pledge via credit, debit or automatic draft, please visit the St. Ambrose website – www.stambroseva.org

- Online Giving is a direct payment program whereby your contribution is debited automatically from your checking, savings, or credit card account into our church's bank account. Follow the instructions to either log in to an existing account or create a new account.

Gifts From Retirement Accounts:

The IRA Charitable Rollover provision of the 2015 PATH (Protecting Americans from Tax Hikes) Act permits individuals age 70.5 or older to contribute up to \$100,000 from a qualifying retirement account directly to St. Ambrose, without recognizing the assets transferred to the charity as income. Please contact your financial advisor for additional information concerning gifts via retirement accounts.

GIFTS OF LIFE INSURANCE, ANNUITIES, WILLS OR BEQUESTS

There are different ways to support St. Ambrose Parish both today and in the years to come via planned giving.

- Families or individuals can make gifts of real estate, personal property, automobiles, life insurance, estate bequests, annuities or charitable remainder trusts.
- For substantial gifts of property other than marketable securities

Federal and state laws on income and inheritance taxes encourage charitable giving. It may be particularly advantageous for some people to contribute stocks, appreciated securities, annuities, property or other valuables. In many cases, the tax savings may be more than your original investment in the gift. Because each situation is unique, we urge you to discuss such donations with a financial advisor.



An Appeal for Your Special Generosity...

Please prayerfully consider your involvement in the campaign. God has given each of us so much. Our hope is that, upon reflection, your generosity will mirror God's goodness to us all. Individuals who are financially capable of pledging \$10,000, \$25,000, \$50,000, \$100,000 or more are asked to step forward and become leaders of our campaign. Your example and generosity will provide the needed momentum and enthusiasm for a successful campaign.

In Deuteronomy 16:10 we are reminded:

“The measure of your own voluntary offering which you will give shall be in proportion to the blessing the Lord, your God, has given you”.

Please review the Suggested Gift Plans on the previous page and choose a plan that is right for you and your family.



CAMPAIGN PRAYER

Father in Heaven,

you sent St. Ambrose
to build your Church on earth
by his preaching of the Gospel.

Through his intercession,
may we build the parish church
we need for the care
of our growing parish.

Give success to the work of our hands;
make us generous in offering
ourselves and our resources
for this worthy cause.

We ask this through your Son,
Jesus Christ, who is Lord
forever and ever.

~AMEN

Fundraising Consultant
Guidance In Giving, Inc.
Stewardship, Development & Campaign Consultants
www.guidanceingiving.com

Thank You Volunteers

Many people contribute to the
life of our parish and provide
vision for our future.

Our deepest gratitude extends
to those who have given the
gifts of their time and talents to
make this project a success.

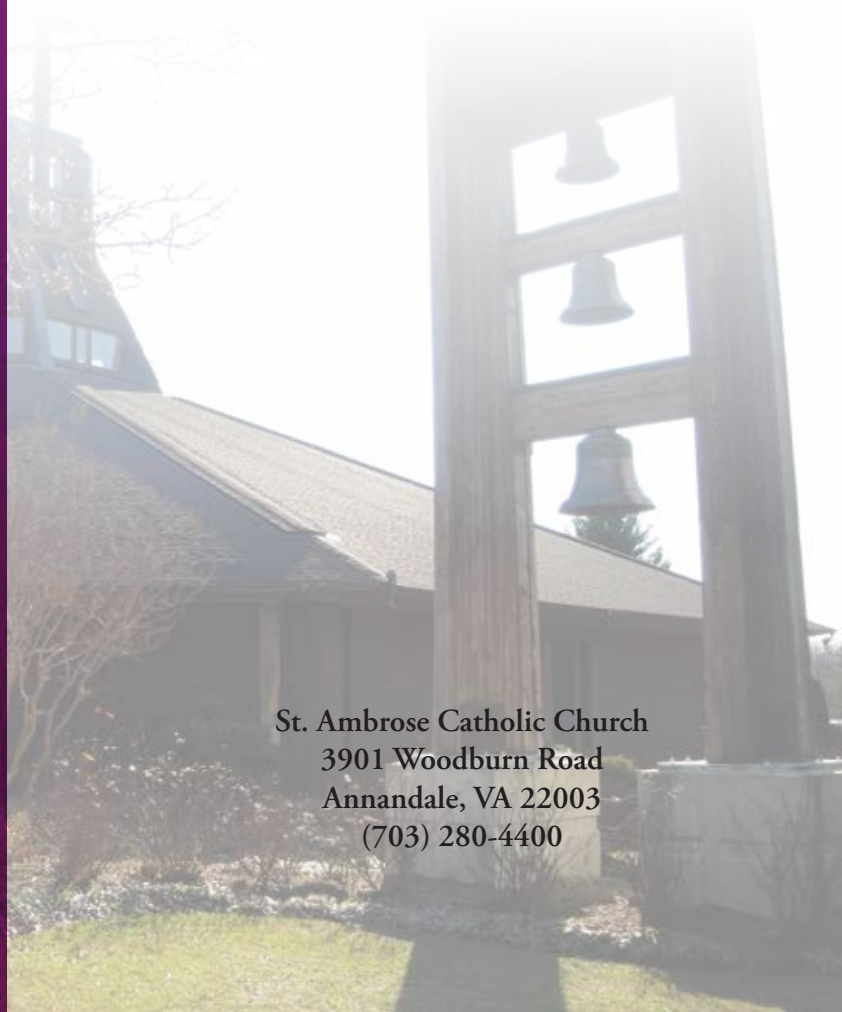

St. Ambrose Catholic Church
3901 Woodburn Road
Annandale, VA 22003
(703) 280-4400